



# CCTV95

## HIGH TEMPERATURE AND NEUTRON TOLERANT CCTV CAMERA

The CCTV95 is designed for areas with high levels of gamma and neutron radiation. A typical surveillance area is the containment in a VVER reactor. The camera features an internal cooling system in order to handle high temperatures and humidity in the containment during a possible LOCA.

### APPLICATIONS

- Surveillance of the containment in a VVER reactor.

### BENEFITS

- Auto-focus and auto-iris
- Very neutron and gamma tolerant color camera
- Powerful optical zoom

### SPECIFICATIONS

Dimensions	364 x 217 x 272 mm (14.33" x 8.54" x 10.71")
Weight	41.1 kg (90.6 lbs)
Housing material	Stainless steel EN 1.4301
Radiation tolerance (dose rate)	1 800 Gy/h (180 000 rad/h)
Radiation tolerance (total dose)	18 000 Gy (1 800 000 rad)
Radiation tolerance neutrons	Very high
Maximum temperature	60°C (140°F), 90°C (194°F) for 5 hours
Cooling	Peltier elements
Protection class	IP65
Zoom	x10 optical x10 digital giving x100
SD horizontal angle of view	Approx. 37.5° (wide end), approx. 4° (tele end)
Resolution SD version	720 TV-lines

*We reserve the right to alter specifications without prior notice*

## CCTV95 IMAGES

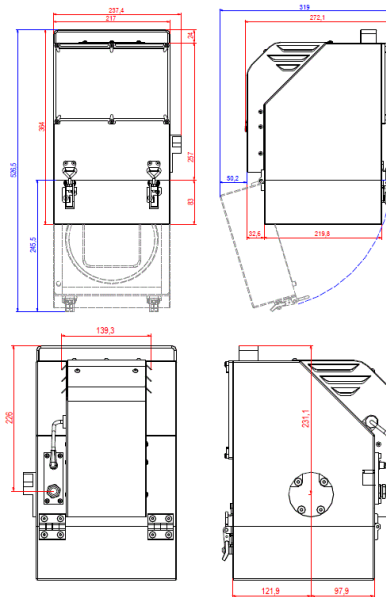

*We reserve the right to alter specifications without prior notice*